

MICROH

PROFESSIONAL PRODUCTS

www.microhpro.com



USER MANUAL

LED COB 100 PAR CWWW

Please read this user manual before using this product

Introduction

Thank you for purchasing the MICROH LED COB100 PAR CWWW. For your own safety and knowledge, please read this manual before installing or operating this device. This manual covers the important information on installation and applications. Please install and operate the fixture according to instructions. Meanwhile, please keep this manual for future reference.

Please carefully unpack the fixture and check all areas to see if it was damaged during transportation. Please check whether the following items are included in the package:

Item	Quantity
LED COB100 PAR CWWW fixture	1
Power cord	1
Gel Frame	1
User manual	1

Notify the shipper immediately and retain packing material for inspection if any parts appear damaged from shipping or the carton itself shows signs of mishandling. Save the carton and all packing materials. In the event that a fixture must be returned to the factory, it is important that the fixture be returned in the original factory box and packing.

Safety Warning

- Every person involved with the installation, operation and maintenance of this device must be qualified.
- User/installer must follow the instructions of this manual.
- Unqualified persons must not open the housing cover and operate the device, or the dealer will not accept liability for any resulting defects or problems.
- Protect the device against rain and moisture device with other electrical equipment.
- During move and installation, make sure the device is not stored with metal parts and other tough materials.
- Always disconnect from the main power sources. Do not install or dismantle when the device is powered on.
- The minimum distance between light output and the illuminated surface must be more than 50cm.
- The device must only be installed on a non-flammable surface. In order to safeguard sufficient ventilation, please leave 50cm of free space around the device. Note that heat-sensitive objects may be deformed or damaged by the emitted heat of this fixture.
- During operation, the housing may become very hot! Do not operate the device for 15 minutes after switching off.
- The maximum ambient temperature $T_a = 45^{\circ}$ (must never be exceeded). The maximum housing temperature $T_b = 80^{\circ}$ (must never be exceeded).
- This fixture is for indoor use.
- Replace any visible cracked protective shields, filters, and lenses.
- The protective shields, filters, and lenses will require weekly cleaning as smoke “cfluid” tends to build up residues, reducing the light output very quickly.



CAUTION!

Never touch the device during operation!
The housing may heat up!



CAUTION!

Never look directly into light source,
as sensitive persons may suffer from an epileptic shock.

Caution!

- Unqualified person involved with installation, operation and maintenance of this device is prohibited.
- If any of the above mentioned problems happen, or unknown problems happen, please contact manufacturer or distributor for assistance.

Operation

After you connected the effect to the mains, The fixture starts running
Stand Alone operation In the stand alone mode, the fixture can be used without a dmx controller

Master/slave-operation

The master/slave-operation enables that several devices can be synchronized and controlled by one master-device. All the slave units will follow the effect of the master unit.

DMX controlled operation

You can control the unit individually via your DMX-controller. The unit uses 4 DMX Channels.

Addressing

The Digital Display on the unit allows you to assign the DMX starting address, Note; it is necessary to insert the XLR termination plug (with 120ohm) in the last device in the link in order to ensure proper transmission on the DMX data link.

Digital Display

The Digital Display on the unit offers several features. It is very easy to change the operation modes in the unit from the Digital Display.

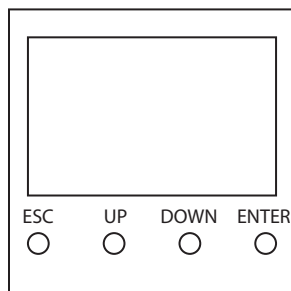

The main menu is accessed by pressing the Mode/Esc-button, Browse through the submenu by pressing Up or Down .Press the Enter-button in order to select the desired menu. You can change the selection by pressing Up or Down, confirm every selection by pressing the Enter-button. You can leave every mode by pressing the Mode/Esc-button. The functions provided are described in the following setting.

Menu Map

The device has two operation modes, It can be operated in Stand Alone or in DMX controlled When in Master/Slave Synchronization Mode, only one in a series chain can be set as the master.

STAT	A.000 Adjust cold white from 000-255 b.000 Adjust warm white from 000-255 ST.000 Adjust strobe effect from 00-20
RUN	DMX and SLAV mode for selection
DMX	Adjust DMX value from 001 to 512
TEMP	CURR show current fixture temperature

Note:

output default setting address code is A001, pan is positive circumrotate, tilt is positive circumrotate, LED positively reveal.

Master/slave mode(auto-running, sound control)

This mode will allow you to link up 32 units together without a controller. Use standard DMX cables to daisy chain your units together via the DMX connector on the rear of the units.Proper performance it may be necessary to use a terminator at the last fixture.

Mounting And Installing

Caution: for added protection, mount the fixture in areas outside walking paths, seating areas, or in areas where the fixture might be reached by unauthorized personnel. Before mounting the fixture to any surface, make sure that the installation area can hold a minimum point load of 10 times the device's weight. Fixture installation must always be secured with a secondary safety attachment, such as an appropriate safety cable. Never stand directly below the device when mounting, removing, or servicing the fixture.

Whether installing inverted on a truss or ceiling, or set on a flat level surface, be sure this fixture is kept at least 0.5m (1.5ft) away from any flammable materials (decorations, etc.). Always use and install the supplied safety cable as a safety measure to prevent accidental damage and/or injury in the event the clamp fails.

Mounting Points: Overhead mounting requires extensive experience, including calculating working load limits. A knowledge of the installation material being used, and periodic safety inspection of all installation material and the fixture are all imperative and should only be performed by a qualified technician. Improper installation can result in bodily injury or damage.

Clamp Mounting: The MICROH LED COB100 PAR CWWW provides a unique mounting bracket assembly that integrates 2 brackets to be used to mount on a truss or the floor. When mounting this fixture to a truss, be sure to secure an appropriately rated clamp to the included bracket fitted through the center hole. As an added safety measure, be sure to attach at least one properly rated safety cable to the fixture.



Regardless of the rigging option you choose for your MICROH LED COB100 PAR CWWW fixture, always be sure to secure your fixture with a safety cable. The fixture provides a built-in rigging point for a safety cable hanging bracket. Be sure to only use the designated rigging point for the safety cable and never secure a safety cable to a carrying handle.

DMX -512 Control Connections

This fixture complies with international USITT DMX standards and can be used with a 3 pin DMX connector. Plug in the 3 pin XLR cable to the female 3 pin XLR output of your controller and the other side to the male 3 pin XLR input of the fixture. To connect the units to DMX, you must daisy chain the fixtures together as a referred in the diagram below. Always end your DMX-512 connection with at DMX terminator.

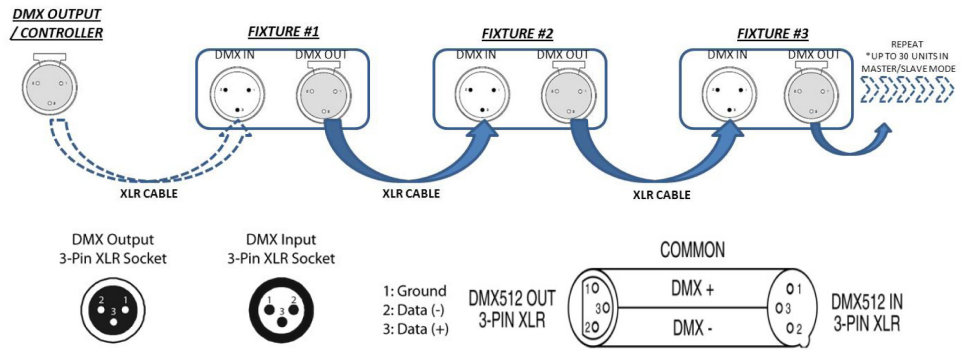

For installations where the DMX cable has to run for a long distance, or as an electrically noisy environment, it is recommended to use a DMX terminator. This helps in preventing corruption of the digital control signal by electrical noise. The DMX terminator is simply an XLR plug with a 120 resistor connected between pins two and three, which is then plugged into the output XLR socket of the last fixture in the chain.

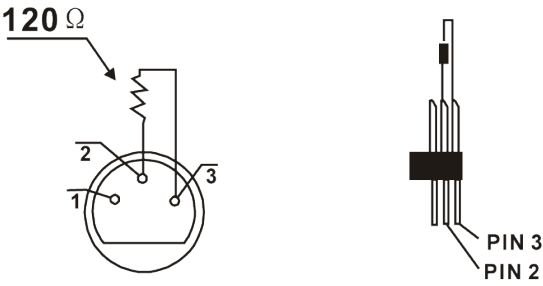

DMX Modes

4CH Mode

Channel	Value	Function
1	000-255	Master Dimmer (0-100%)
2	000-255	Cool White Dimmer (0-100%)
3	000-255	Warm White Dimmer (0-100%)
4	000-010	No Function
	011-255	Strobe (slow to fast)

Features

- Cool White & Warm White LEDs
- Strobe LEDs

Specifications

Lamp	100 Watt CW/WW LED
LED Life	50,000hr
LEDs	2 in 1 CWWW COB
Power	110V-250V 50/60Hz
Power Consumption	110W 1A
Power Connection	IEC out
Data Connection	3Pin XLR
Colours	Cool White, Warm White
Modes	DMX, Master/Slave, Auto
DMX Channels	4CH
Dimmer	0-100% Linear dimmer
Dimensions (mm)	370(H) x 250(W) x 250(L)
Weight	3.8Kgs

Maintenance and Cleaning

The following points have to be considered during the inspection:

1. All screws for installing the device, or parts of the device must be tightly connected, and must not be corroded.
2. There must not be any deformations on the housing, colour lenses, fixations or installation spots (ceiling, suspension, trussing).
3. Mechanically moved parts must not show any traces of wearing and must not rotate with unbalances.
4. The electric power supply cables must not show any damage, material fatigue or sediments.

Further instructions depending on the installation spot and usage must be handled by a skilled installer or technician. Any safety issues must be resolved.

CAUTION!

Disconnect fixture before servicing.



In order to keep the fixture in good condition and extend the life, we suggest regular cleaning to the fixture.

1. Clean the inside and outside lens each week to avoid the light output from darkening due to accumulation of dust, dirt, etc.
2. Clean the fan each week.
3. A detailed electrical check by an approved technician every three months is advised. Ensure the circuit contacts are in good condition, and prevent from overheating.

We recommend a frequent cleaning of the device. Please use a moist, lint-free cloth. Never use alcohol solvents.

There are no serviceable parts inside the device. Please refer to the instructions under "Installation Instructions."

Should you need any spare parts, please order genuine MICROH parts from your local dealer.



CAUTION!

Take care using this equipment! High voltage risk of electric shock!

PLEASE NOTE:

All information for this product is subject to change without notice!

MICROH
PROFESSIONAL PRODUCTS

For more information please contact:

www.microhpro.com
info@microhpro.com
905.428.9062